

## HEAVY HEX BOLTS A325 & A490

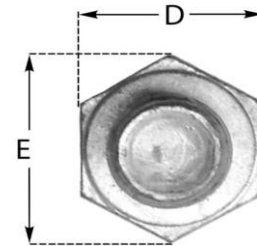
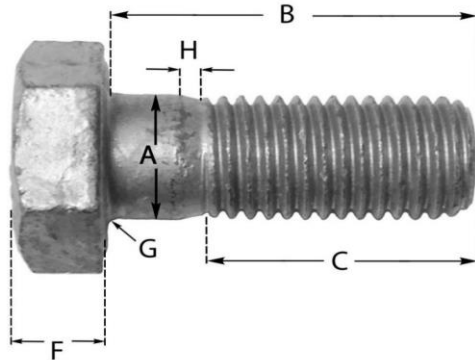

STRUCTURAL BOLTS, A325 & A490															
Nominal or Basic Screw Diameter		B: The length of Cap Screws is measured from the underhead bearing surface to the end of the screw.													
		A		C	D		E		F			G		H	
		Body Diameter		Thread Length	Width Across Flats		Width Across Corners		Head Height			Radius of Fillet		Transition Thread Length	
Max	Min	Ref	Basic	Max	Min	Max	Min	Basic	Max	Min	Max	Min	Max, Ref		
1/2	0.5000	0.515	0.482	1.00	7/8	0.875	0.850	1.010	0.969	5/16	0.323	0.302	0.031	0.009	0.19
5/8	0.6250	0.642	0.605	1.25	1-1/16	1.062	1.031	1.227	1.175	25/64	0.403	0.378	0.062	0.021	0.22
3/4	0.7500	0.768	0.729	1.38	1-1/4	1.250	1.212	1.443	1.383	15/32	0.483	0.455	0.062	0.021	0.25
7/8	0.8750	0.895	0.852	1.50	1-7/16	1.438	1.394	1.660	1.589	35/64	0.563	0.531	0.062	0.031	0.28
1	1.0000	1.022	0.976	1.75	1-5/8	1.625	1.575	1.876	1.796	39/64	0.627	0.591	0.093	0.062	0.31
1-1/8	1.1250	1.149	1.098	2.00	1-13/16	1.812	1.756	2.093	2.002	11/16	0.718	0.658	0.093	0.062	0.34
1-1/4	1.2500	1.277	1.223	2.00	2	2.000	1.938	2.309	2.209	25/32	0.813	0.749	0.093	0.062	0.38
1-3/8	1.3750	1.404	1.345	2.25	2-3/16	2.188	2.119	2.526	2.416	27/32	0.878	0.810	0.093	0.062	0.44
1-1/2	1.5000	1.531	1.470	2.25	2-3/8	2.375	2.300	2.742	2.622	15/16	0.974	0.902	0.093	0.062	0.44

Tolerance on Length	Nominal Screw Size	Nominal Screw Length	
		Through 6 inches	Over 6 inches
	1/2	-0.12	-0.19
	5/8	-0.12	-0.25
	3/4 through 1	-0.19	-0.25
1-1/8 through 1-1/2	-0.25	-0.25	